

Latch Contra Angle Attachment

OPERATION MANUAL

3839 AUTOCLAVABLE
184 OM-CK285E 002

⚠ Caution before use

- The Patterson attachment is intended for use by dental professionals only.
- Read this operation manual carefully before using the attachment.
- Be sure to follow all the operating instructions, including all cautions and warnings.
- Keep this Operation Manual for future reference.
- Consider primarily the safety of the patient and the operator when using the attachment.

1. Specifications

HEAD: 043-4092 NAC-Y
HEAD: 043-2005 BB-Y
HEAD: 043-3839 NPB-Y

Item Number	043-4092 NAC-Y	043-2005 BB-Y	043-3839 NPB-Y
Applicable burs	ISO 2.34 latch bur	ISO 2.34 latch bur	ISO 2.34 latch bur
Installation/removal of bur	Traditional type	Traditional type	Pushbutton type
Allowable max. speed	30,000rpm	40,000rpm	40,000rpm
Applicable contra angle sheath	043-4126 ISO E-type, 1:1 drive type 043-2542 ISO E-type, 4:1 speed reduction type		

2. Installation/Removal of Head onto/from Contra Angle Sheath

- Perform installation/removal of head onto/from the contra angle sheath. Refer to instructions 8: Replacement of Head.

⚠ Caution

- Never use the attachment if it cannot be smoothly installed onto or removed from the contra angle sheath. **In such a case, consult the Patterson Service Center.**

3. Installation/Removal of bur into/from Attachment

NAC-Y and BB-Y

- Swing the latch plate out, holding the sheath connected to the head.
- Insert a bur into the chuck hole until the end of the bur touches the back of the chuck.
- Swing the latch plate back until it snaps at the center of the collar of the contra angle head.
- Make sure that the bur is locked securely with the latch, pulling the bur with fingers and rotating it manually.

NPB-Y

- Holding the sheath connected to the head, press the head button with thumb to open the chuck and then insert a bur into the chuck hole. When the end of the CA bur touches the back of the chuck, release the head button.
- Make sure that the bur is securely fixed after the installation, pulling the bur with your fingers and rotating it manually.

⚠ Caution

- Never use non-ISO standard, damaged or worn-out burs.
- Use clean burs. Dirt or debris stuck to the bur shank may clog the chuck mechanism.

4. Operation

NAC-Y

- Setting the motor speed below 30,000rpm, perform a test run of the attachment, making sure that the bur is securely installed.
- Use the attachment, setting the motor speed appropriately.

BB-Y and NPB-Y

- Setting the motor speed below 40,000rpm, perform a test run of the attachment, making sure that the bur is securely installed.
- Use the attachment, setting the motor speed appropriately.

⚠ Warning

- When abnormal vibration, noise, overheating, etc., occurs while the attachment is in the test run or in use, stop using the attachment immediately. **In such a case, consult the Patterson Service Center.**
- **NAC-Y and BB-Y:** Never swing the latch plate out when the motor is rotating.
- **NPB-Y:** Never press pushbutton when the motor is rotating.
- Never connect/disconnect the attachment when the motor is rotating.
- **NAC-Y:** Never set motor speed above 30,000rpm.
- **BB-Y and NPB-Y:** Never set motor speed above 40,000rpm.

5. Cleaning and Drying

Cleaning and Drying the Exterior

Wash the handpiece under running water following the procedures below. (Water condition: ≤100°F, ≥3.5L/min; water should be of the same quality as drinking water)

- Clean the external surfaces of the handpiece with a soft bristled toothbrush for 15 seconds or more.
- Clean around the bur insertion hole for 15 seconds or more, using an interdental brush (wire thickness 0.7mm) that conforms to size 4 in ISO 16409.

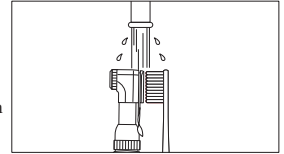

- Under appropriate lighting (natural office lighting, 500 lx or higher), inspect the handpiece for blood or other debris. If any visible debris remains, repeat the process until the handpiece is visually clean.

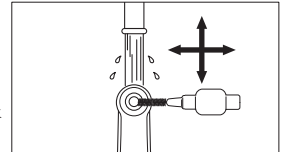

After cleaning, if the residual moisture is present, wipe off with dry cloth or blow it off with compressed air (≤50.75psi) until there is no moisture in the interior and exterior.

When blowing off with compressed air, cover the handpiece with cloth to prevent scattering of water. Proceed to 6: Cleaning and Lubrication.

6. Cleaning and Lubrication

Cleaning and Lubricating the Interior

- Attach an E-Type spray nozzle to the nozzle of the PANA SPRAY Plus.
- Shake the can 3 or 4 times and insert the E-Type spray nozzle into the rear of the handpiece while holding the head of the handpiece with a cloth etc.
- Hold the handpiece and spray for 2 or 3 seconds until oil comes out of the handpiece head. Repeat lubrication until foreign material stops coming out of the tip.

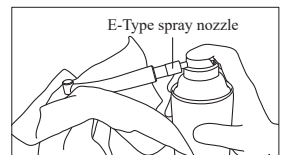

Caution

- Do not use sprays other than PANA SPRAY Plus. Using sprays other than PANA SPRAY Plus may cause the handpiece to overheat.
- Hold the spray can upright.
- Firmly hold the handpiece to prevent it slipping when spray pressure is applied.
- Spray lubricant until it expels from the handpiece head.
- If you wish to purge excessive oil from inside the handpiece, rotate the handpiece for approx 15 seconds without a bur. During the rotation, do not depress the push button, especially when using absorbent cloth to prevent oil from scattering. Depressing the push button during rotation may damage the chuck mechanism. (NPB-Y)

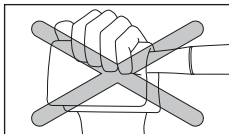
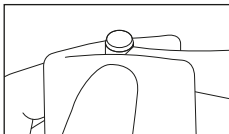

7. Sterilization

Autoclaving is recommended for sterilization.

- Before sterilization, clean the surface of the attachment and lubricate the attachment (refer to instructions 5: Cleaning and Drying and 6: Cleaning and Lubrication).
- Put the attachment into a sterilization pouch by itself.
- Place the attachment in the center or upper shelf of the autoclave chamber.
- Autoclave the handpiece at 275°F for 20 minutes.

Caution

- Never use dry heat sterilization, cold sterilization, etc.
- Never autoclave the attachment with other instruments in the same sterilization pouch.
- Never place the attachment at the bottom of the autoclave chamber, as the temperature at the bottom may rise above the actual setting temperature.

8. Replacement of Head

The replacement head is supplied with a transmission gear.

- Remove the head from the sheath with your fingers, turning the union nut clockwise. Pull the transmission gear out from the head.
- Insert the transmission gear supplied with the replacement head into the sheath. Align the clutch of the head with that of the sheath. Then install the head onto the sheath, turning the union nut counterclockwise with your fingers.
- Lubricate the attachment. (refer to instructions 6: Cleaning and Lubrication.)

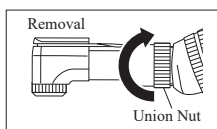

9. Replacement of Cartridge

NAC-Y and BB-Y

- Swing the latch plate out. Pull the transmission gear out from the head.
- Remove the front cap as illustrated using the wrench.
- Push the used-up cartridge out from the head using a pin or driver.
- Insert the new cartridge into the head, aligning the knob of the cartridge with the slit inside the head as illustrated.
- Fix the head cap. Swing the latch back to the original position.
- Insert the transmission gear into the head, then rotate it manually with your fingers so that the transmission gear engages with the gear inside the head.
- Lubricate the attachment, then perform a test run.

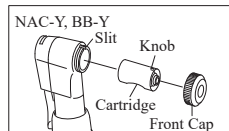
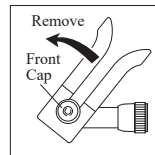

NPB-Y

- Pull the transmission gear out from the head.
- Remove the head cap using the wrench.
- Push the used-up cartridge out from the head using a pin or driver.
- Insert the new cartridge into the head, aligning the knob of the cartridge with the slit inside the head.

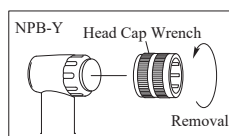

- Put the latch plate on the cartridge.
- Fix the head cap.
- Insert the transmission gear into the head, and then rotate it manually with fingers so that the transmission gear engages with the gear inside the head.
- Lubricate the attachment, then perform a test run.

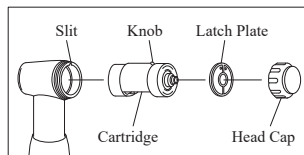

10. Guarantee

Patterson guarantees the head for six months and the sheath for 10 months subject to observance of maintenance instructions, cautions, warnings and normal use.

Note

- Patterson reserves the right to analyze and determine the cause of any failure.
- Guarantee is void if the breakage, accident or any other issues are caused by the neglect of daily maintenance, cautions, warnings or common sense in use.
- Dismantling or reassembling by any third party other than the Patterson Service Center, except the replacement of the head, the replacement of the cartridge and the disassembling instructions for lubrication, voids guarantee.

Pour une version en français du manuel d'utilisation, veuillez vous rendre sur le site Web de Patterson:
<https://www.pattersondental.com/fr-CA>

Manufactured for:
Fabriqué pour :

Patterson Dental Supply, Inc.
1031 Mendota Heights Road
Saint Paul, MN 55120